

FLOOR PLAN, DIMENSIONS & MAP

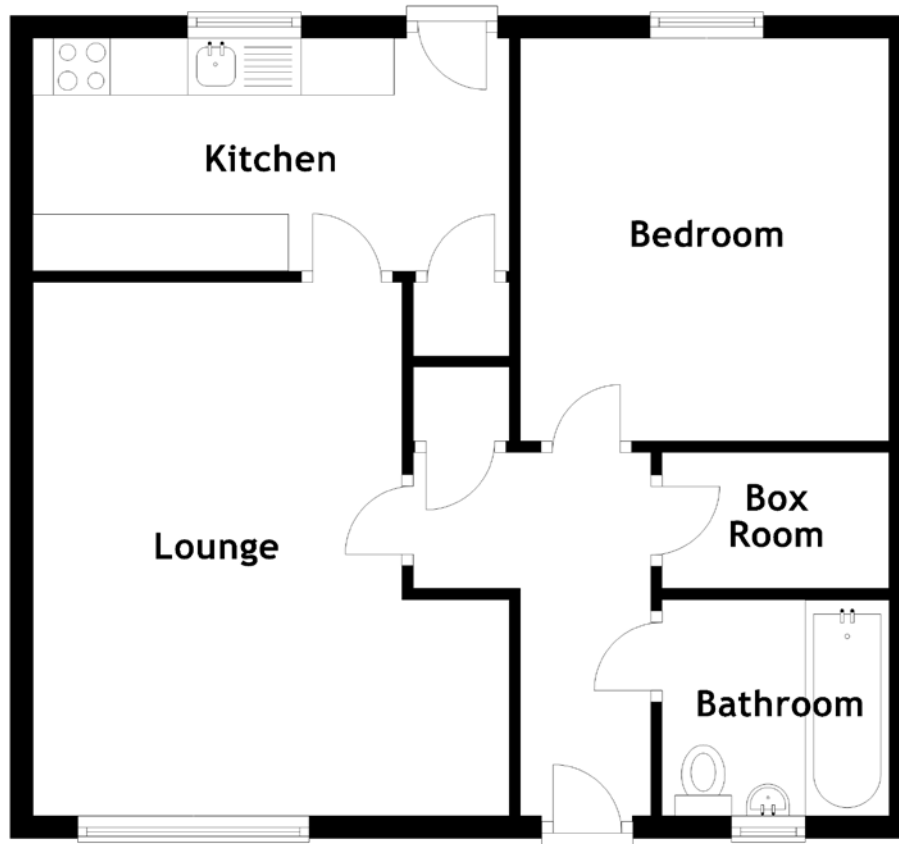

Approximate Dimensions (Taken from the widest point)

Lounge	4.70m (15'5") x 4.20m (13'9")
Kitchen	4.25m (13'11") x 2.05m (6'9")
Bedroom	3.55m (11'8") x 3.25m (10'8")
Box Room	2.00m (6'7") x 1.20m (3'11")
Bathroom	2.00m (6'7") x 1.90m (6'3")

Gross internal floor area (m²): 50m²
EPC Rating: C

Extras: Floor coverings, light fittings, blinds in the living room and kitchen. Curtains and curtain poles are not included.

