



## 4 Kildare Place

Newmains, Wishaw, ML2 9FB

### Offers over £87,000

UNEXPECTEDLY BACK ON THE MARKET!

An immaculate ground floor apartment situated within an exclusive modern and private development within Newmains, Wishaw.

The accommodation comprises bright welcoming hallway, a spacious lounge with French doors opening to a Juliet balcony, modern fitted dining kitchen with all appliances of integrated oven, hob, cooker hood, washing machine, dishwasher, fridge and freezer, 2 double bedrooms and a contemporary style bathroom.

Lovely landscaped communal gardens to rear with paved patio and sitting areas.

Further benefits include a wealth of storage throughout, ample parking and a secure door entry system. Double Glazing. Gas Central Heating.

EPC C.

Kildare Place is situated central to all local amenities including shops, schooling and transport links, with regular bus services into Wishaw Town Centre. For the commuter the M8 and M74 motorway networks allow for fast and easy access to Glasgow, Edinburgh and all points beyond.

- Immaculate Ground Floor Apartment
- Exclusive Development
- Close to all amenities
- Two double bedrooms
- Dining Kitchen
- Wealth of storage
- Ample parking
- Landscaped garden grounds
- French Doors & Juliet Balcony

### Viewing

Please contact our Pomphreys Properties Ltd Office on 01698373365 if you wish to arrange a viewing appointment for this property or require further information.

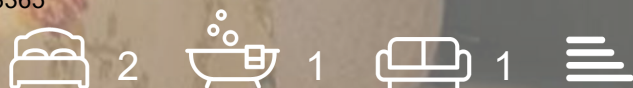

## Floor Plan

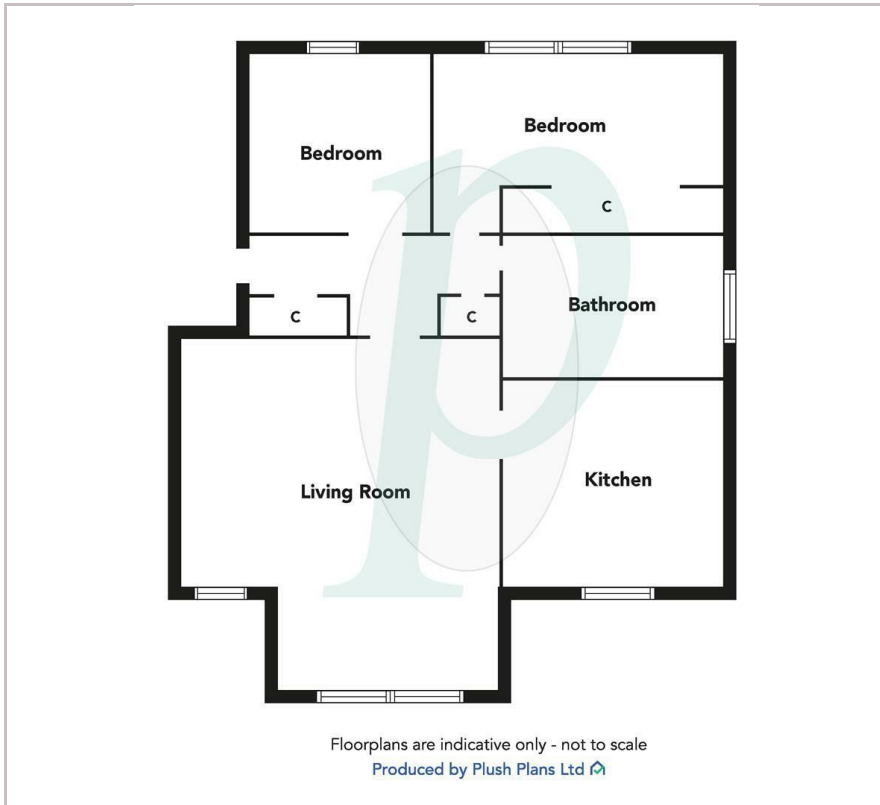

## Area Map



## Energy Efficiency Graph



These particulars, whilst believed to be accurate are set out as a general outline only for guidance and do not constitute any part of an offer or contract. Intending purchasers should not rely on them as statements of representation of fact, but must satisfy themselves by inspection or otherwise as to their accuracy. No person in this firm's employment has the authority to make or give any representation or warranty in respect of the property.