

# Rob Roy Park Homes

THE LYNDALE, CRAWFORD, BIGGAR, SOUTH LANARKSHIRE, ML12 6TW

## Lyndale

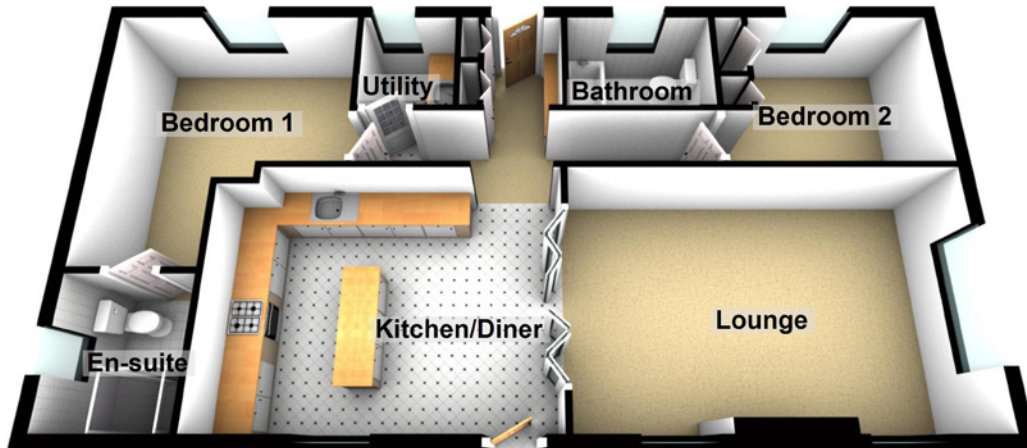

### Approximate Dimensions (Taken from the widest point)

Lounge	5.50m (18'1") x 3.60m (11'10")
Kitchen/Diner	4.80m (15'9") x 3.60m (11'10")
Utility	1.50m (4'11") x 1.50m (4'11")
Bedroom 1	3.95m (13') x 3.60m (11'10")
En-suite	2.05m (6'9") x 1.75m (5'9")
Bedroom 2	3.20m (10'6") x 2.40m (7'10")
Bathroom	2.15m (7'1") x 1.50m (4'11")