

Rob Roy Park Homes

THE LAMPOR, CRAWFORD, BIGGAR, SOUTH LANARKSHIRE, ML12 6TW

Lampport

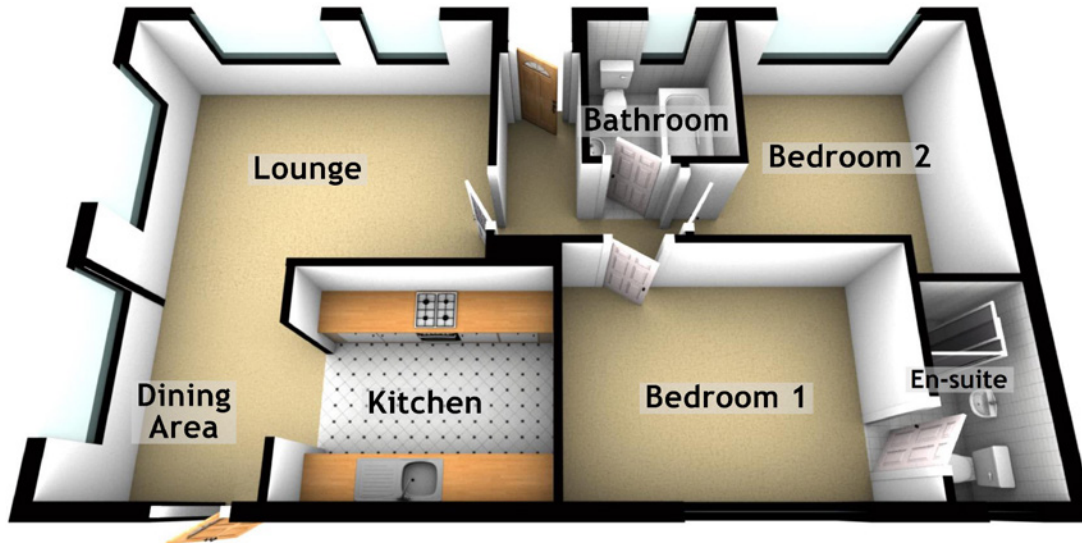

Approximate Dimensions (Taken from the widest point)

Lounge	4.46m (14'8") x 3.18m (10'5")
Dining Area	2.50m (8'2") x 2.25m (7'5")
Kitchen	2.87m (9'5") x 2.50m (8'2")
Bedroom 1	3.85m (12'8") x 2.78m (9'1")
En-suite	2.32m (7'7") x 1.14m (3'9")
Bedroom 2	3.60m (11'10") x 2.92m (9'7")
Bathroom	1.91m (6'3") x 1.76m (5'9")