

Flat 2-1, 84 Balerno Drive, Mosspark, Glasgow G52 1NA

Approximate Gross Internal Area

740 sq ft - 69 sq m

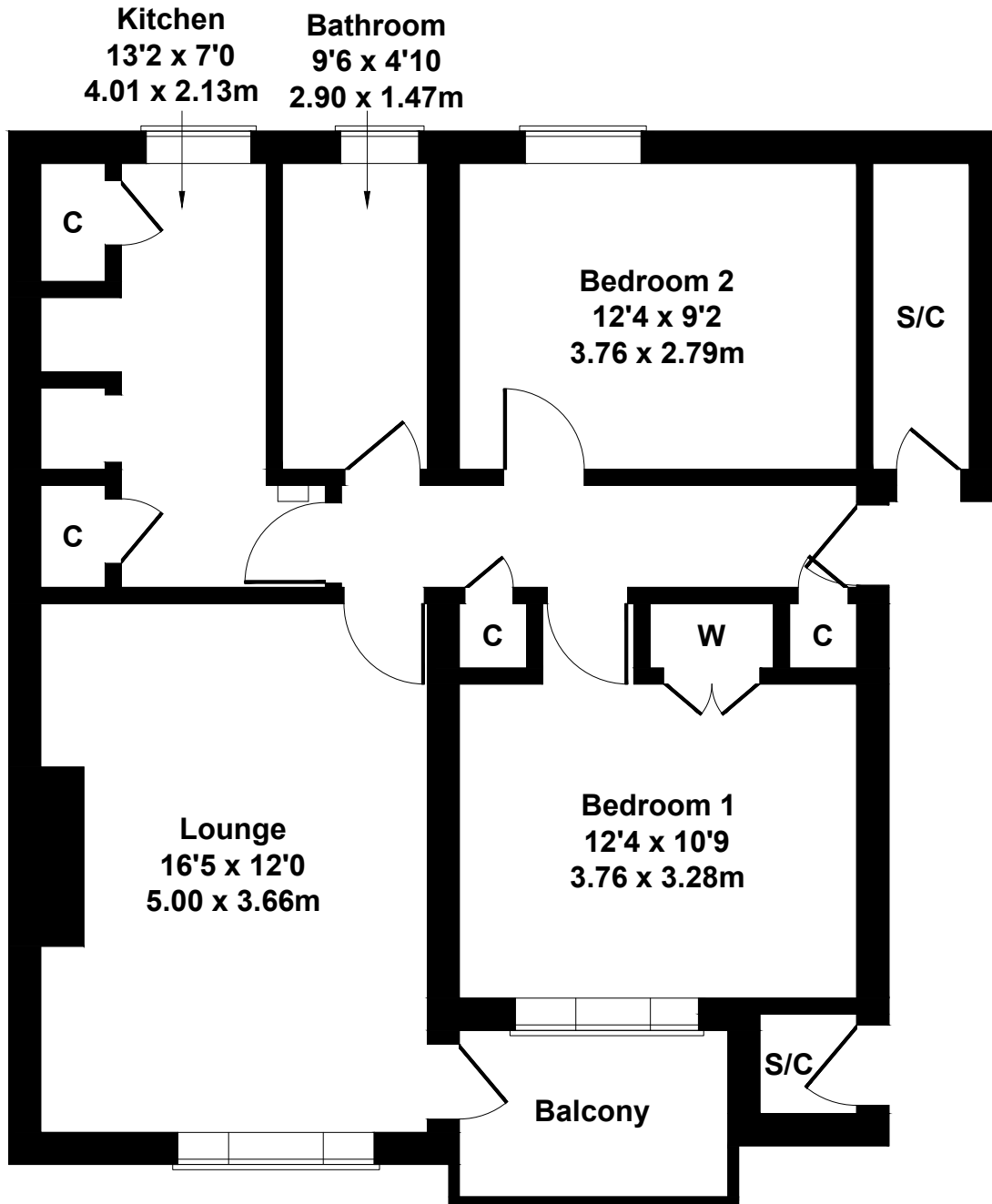

SKETCH PLAN FOR ILLUSTRATIVE PURPOSES ONLY

All measurements walls, doors, windows, fittings and appliances, their sizes and locations, are approximate only. They cannot be regarded as being a representation by the seller, nor their agent.