



McEwan Fraser Legal
Solicitors & Estate Agents
01224 472 441

19D Stafford Street

ABERDEEN, ABERDEENSHIRE, AB25 3UP



Aberdeen

ABERDEENSHIRE, AB25 3UP

Aberdeen city centre is within easy reach with good access from this location, the city provides all that one would expect from modern-day living, including a multitude of shopping malls and local shops. There are pubs, restaurants, eateries galore, with fantastic theatres and cinemas to enjoy.

The city offers excellent bus and rail service with national and international flights provided from Dyce Airport. The main East Coast rail network operates from Aberdeen providing a link to the central belt, the south and beyond.

Stafford Street is ideally located within easy walking distance to Aberdeen University, Aberdeen College, the retail parks at Berryden and Kittybrewster and several convenience stores closeby. The city centre is also within easy reach as is regular public transport giving access to all areas of the city.



19D Stafford Street

ABERDEEN, ABERDEENSHIRE, AB25 3UP

McEwan Fraser Legal is delighted to present to the market this 1 bedroom flat located in a popular city location.

The property forms part of a traditional granite tenement with the building protected by a secure entry system. The flat is in walk-in condition and benefits from newly fitted double glazing.

The location is ideal for the nearby university, local facilities and has good nearby local transport links to other areas of the city.

Inside, the property comprises of:

- Entrance hallway leading to upper floors.
- Interior hall.
- Fully equipped kitchen with ample base and wall units with space for appliances and dining.
- Spacious Lounge.
- Double bedroom.
- Fully tiled bathroom with electric shower over the bath.

To the exterior, there is permit on-street parking to the front as well as a communal garden to the rear. Viewings are by appointment only.





Specifications & details

FLOOR PLAN, DIMENSIONS & MAP

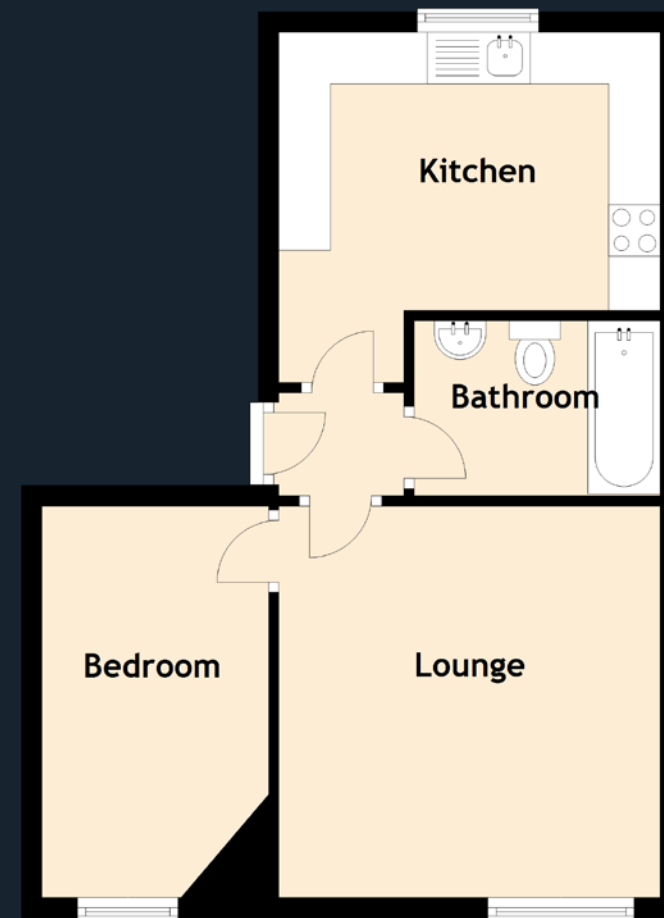

Approximate Dimensions (Taken from the widest point)

Lounge	3.80m (12'6") x 3.70m (12'2")
Kitchen	3.60m (11'10") x 3.40m (11'2")
Bedroom	3.80m (12'6") x 2.20m (7'3")
Bathroom	2.60m (8'6") x 1.70m (5'7")

Gross internal floor area (m²): 43m² | EPC Rating: E

Extras (Included in the sale): All fixed floor coverings and blinds where applicable. White goods are available by separate negotiation.

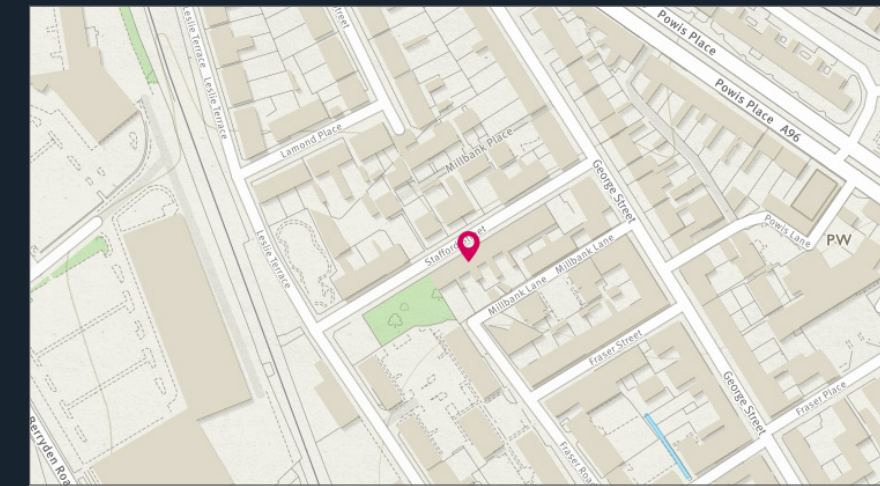

Image credit: <https://www.dunmeurey.co.uk/omags/>



Solicitors & Estate Agents

Tel. 01224 472 441
www.mcewanfraserlegal.co.uk
info@mcewanfraserlegal.co.uk

Part
Exchange
Available

Disclaimer: The copyright for all photographs, floorplans, graphics, written copy and images belongs to McEwan Fraser Legal and use by others or transfer to third parties is forbidden without our express consent in writing. Prospective purchasers are advised to have their interest noted through their solicitor as soon as possible in order that they may be informed in the event of an early closing date being set for the receipt of offers. These particulars do not form part of any offer and all statements and photographs contained herein are for illustrative purposes and are not guaranteed or warranted. Buyers must satisfy themselves for the accuracy and authenticity of the brochure and should always visit the property to satisfy themselves of the property's suitability and obtain in writing via their solicitor what's included with the property including any land. The dimensions provided may include, or exclude, recesses intrusions and fitted furniture. Any measurements provided are for guide purposes only and have been taken by electronic device at the widest point. Any reference to alterations to, or use of, any part of the property does not mean that any necessary planning, building regulations or other consent has been obtained. A buyer must find out by inspection or in other ways that all information is correct. None of the appliances/services stated or shown in this brochure have been tested by ourselves and none are warranted by our seller or MFL.



Text and description
ANDREW REID
 Surveyor



Professional photography
SCOTT MARSHALL
 Photographer



Layout graphics and design
ALLY CLARK
 Designer