



24A Buchanan Drive, Newton Mearns

www.nicolestateagents.co.uk



Nicol Estate Agents



Nicol Estate Agents

Situation

This popular suburb is located approximately 9 miles to the South of Glasgow's City Centre and is conveniently situated for commuter access to nearby M77/M8 & Glasgow Southern Orbital.

Recognised as providing amongst the highest standards of local amenities, Newton Mearns offers an array of healthcare centres, banks and libraries and a broad range of supermarkets, boutique shops and restaurants, including The Avenue Shopping Centre. Only a short walk away are the local shops and Co-op on Harvie Avenue and the Greenlaw Retail Park which includes Waitrose, Tesco Metro, Aldi and a range of bars and restaurants. Patterton Train Station is a short distance from the property.

Local sports and recreational facilities include David Lloyd Rouken Glen, Parklands Country Club, Williamwood, Whitecraigs and Cathcart Golf Clubs and Whitecraigs Tennis Club, as well as East Renfrewshire Council's own excellent sports and leisure facilities at Eastwood Toll. If you are an outdoors lover, Rouken Glen Park, voted Best Park in the UK 2016, is nearby with walking trails through the woods, a great adventure play area, a skate park, five a side football pitches and a boating pond.

In addition, this property sits within the catchments area for the highly reputable Primary and Secondary schools.





Description

A well presented two bedroom ground floor flat, built by Dickie, situated within this popular development with attractively landscaped resident's gardens, close to local amenities and Patterson Train Station.

At present, the accommodation comprises:

Controlled door entry security system leads to a well-kept and illuminated communal entrance and stair access to all levels. Welcoming reception hallway with storage. A bright and spacious bay window sitting room/dining room overlooking the front of the property. Kitchen with a full complement of wall mounted and floor standing units. Bedroom one with fitted wardrobes. Bedroom two. Shower room with three piece suite completes the accommodation.

The property is further complemented by electric heating and double glazing. Additional residents parking provided.





Nicol Estate Agents



24A Buchanan Drive, Newton Mearns G77 6QX

Approximate gross internal area 799 sq ft - 74 sq m

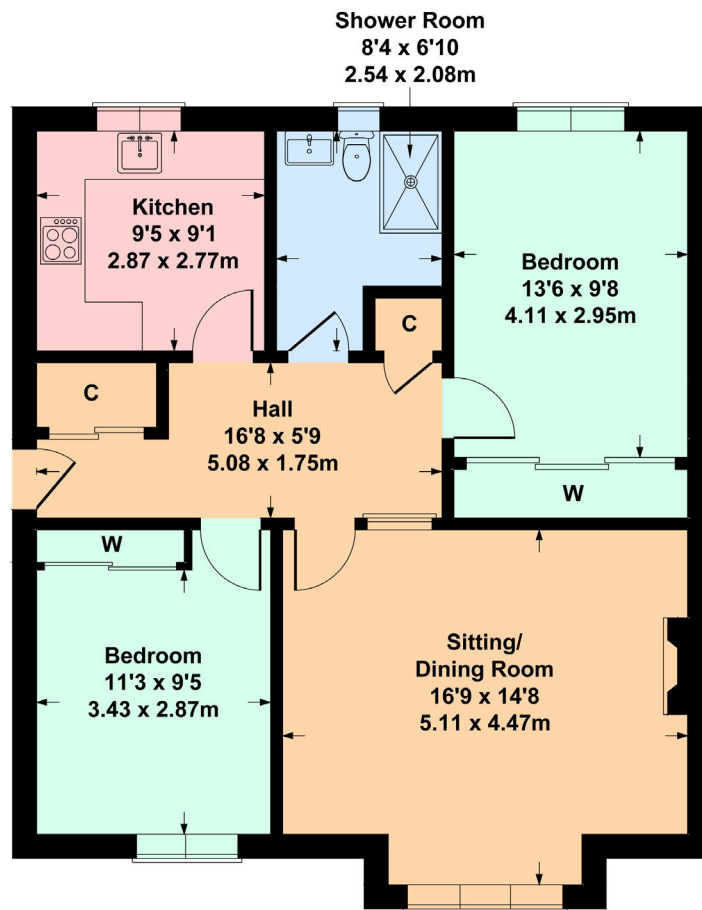

SKETCH PLAN FOR ILLUSTRATIVE PURPOSES ONLY

All measurements, walls, doors, windows, fitting and appliances, their sizes and locations are approximate only. They cannot be regarded as being a representation by the seller, nor their agent.

We believe these details to be accurate however it is not guaranteed and they do not form any part of a contract. Fixtures and fittings are not included unless specified in the enclosed. Photographs are for general information and it must not be inferred that any item is included for sale with the property. All distances and measurements are approximate. Floorplans may not be to scale and are for illustration purposes only.

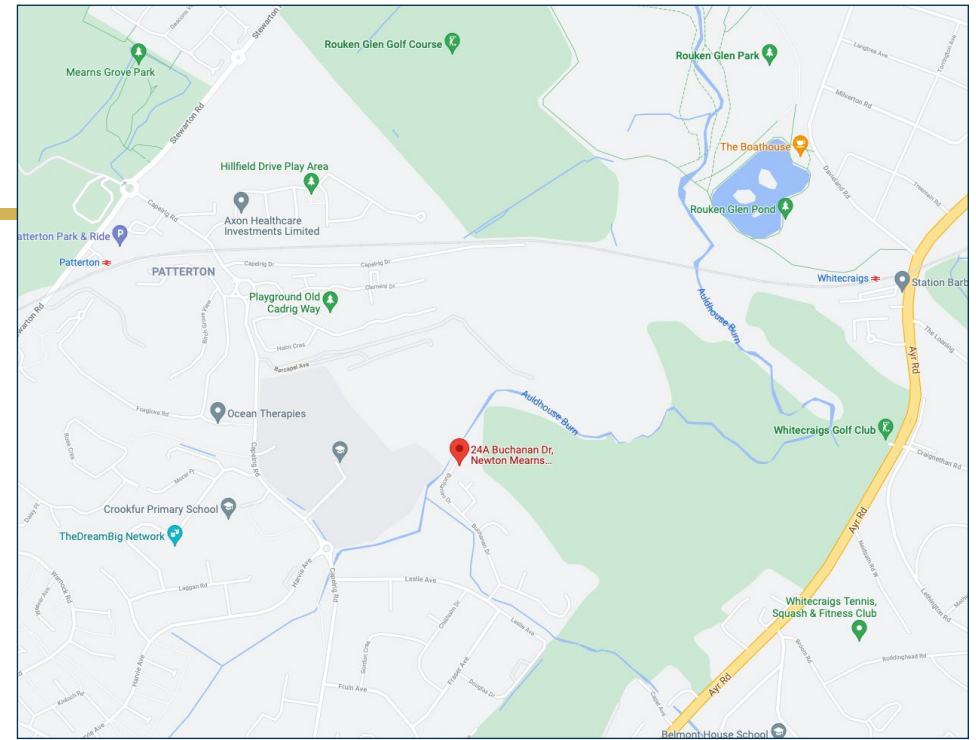

Viewing

By appointment through
Nicol Estate Agents
46 Ayr Road
Newton Mearns, Glasgow G46 6SA
Telephone 0141 616 3960
mail@nicolestateagents.co.uk

Outgoings

East Renfrewshire Council
Council Tax Band: D

Fixtures and Fittings

Only items specifically mentioned in the sale particulars are included in the sale price.

Energy Efficiency Rating

Band D

Services

The property will be supplied by mains water, electricity and drainage. Electric central heating.

Local Authority

East Renfrewshire Council
Council headquarters
Eastwood Park
Rouken Glen Road
Giffnock
G46 6UG
Tel: (0141) 577 3000

Property Reference 2029

46 Ayr Road, Newton Mearns, Glasgow G46 6SA

T: 0141 616 3960 F: 0141 258 2761 E: mail@nicolestateagents.co.uk

www.nicolestateagents.co.uk

