



Penthouse 4, Sandringham Court, Newton Mearns

www.nicolestateagents.co.uk



Nicol Estate Agents



Nicol Estate Agents

Situation

Sandringham Court is one of Glasgow's last remaining lavish Art Deco buildings, sympathetically restored to its former glory, located within the heart of the desirable Broom Estate residential enclave of Newton Mearns.

The Broom Estate displays many individual properties from the pre and post war era, developed by Mactaggart and Mickel Homes and has matured into one of the most sought after and prestigious areas to live within Newton Mearns.

A hugely popular suburb, Newton Mearns is located approximately 9 miles from Glasgow City Centre. Commuter routes are served by the M77, M8 and Glasgow Orbital motorways which also provide 20 - 30 minute journey times to both Glasgow and Prestwick International Airports. There are regular train and bus services to Glasgow, East Kilbride and the Ayrshire coast.

Newton Mearns is recognised as providing amongst the highest standards of local amenities including healthcare centres, banks and libraries and a broad range of supermarkets, boutique shops and restaurants.

Local sports and recreational facilities include Parklands Country Club, Cathcart, Williamwood and Whitecraigs Golf Clubs, Whitecraigs Tennis Club, as well as East Renfrewshire Council's own excellent sports and leisure facilities at Eastwood Toll. Sandringham Court is conveniently located for access to The Avenue Shopping Centre, Waitrose at Greenlaw Village Retail Park, Broomburn Park and local shops at the Broom.















Description

Seldom available, a particularly spacious and well presented two bedroom penthouse apartment positioned within the private and exclusive Sandringham Court development, yet only a short walk to local shops at the Broom and nearby transport links on Mearns Road, located in one of Glasgow's most coveted residential neighbourhoods.

Sandringham Court is surrounded by gated tranquil landscaped gardens and offers a garage and an allocated parking space. The communal areas and apartments offer beautifully retained Art Deco features with the comfort and luxury expected from an exceptional development and restoration.

Constructed by MacTaggart and Mickel around 1939, Sandringham Court comprises two Art Deco blocks. Billed at the time of completion as 'the most luxurious flats in Scotland' this status has now been lovingly resurrected following a sympathetic refurbishment in 2014/2015.

The accommodation extends to approximately 1381 Sqft (128 Sqm) and offers flexible living comprising:

Secure controlled entry leads to a well-kept and illuminated impressive period communal entrance foyer and stairwell. Lift and stair access to all levels. Welcoming and spacious 29' reception hallway with walk in storeroom. An impressive and generous proportioned dual aspect sitting/dining room with sliding door screens opening to a private terrace, enjoying aspects over the surrounding area. Double doors connect to kitchen.

Well appointed 'Alno' dining size kitchen with a full range of floor and wall mounted cabinets, integrated appliances and space for table and chairs. Principal bedroom with fitted wardrobes and an attractive ensuite bathroom. Sliding door screen opens to a second private terrace overlooking Falkland Avenue and the surrounding area. Bedroom two, again of double proportions, with ensuite shower room and fitted wardrobes. An attractive bathroom completes the overall accommodation. All sanitary ware and bathroom tiling is from Porcelanosa.

The property is further complemented by a lock up garage with remote controlled door, gas central heating, double glazing, resident's parking and well kept extensive resident's gardens. The property benefits from a high level of security with controlled door entry system, concierge service and a lift servicing all levels.











Nicol Estate Agents



Penthouse 4, Sandringham Court, Newton Mearns, G77 5DT

Approximate gross internal area
Main house = 1381 sq ft - 128 sq m
Terraces = 154 sq ft - 14 sq m
Total = 1535 sq ft - 142 sq m

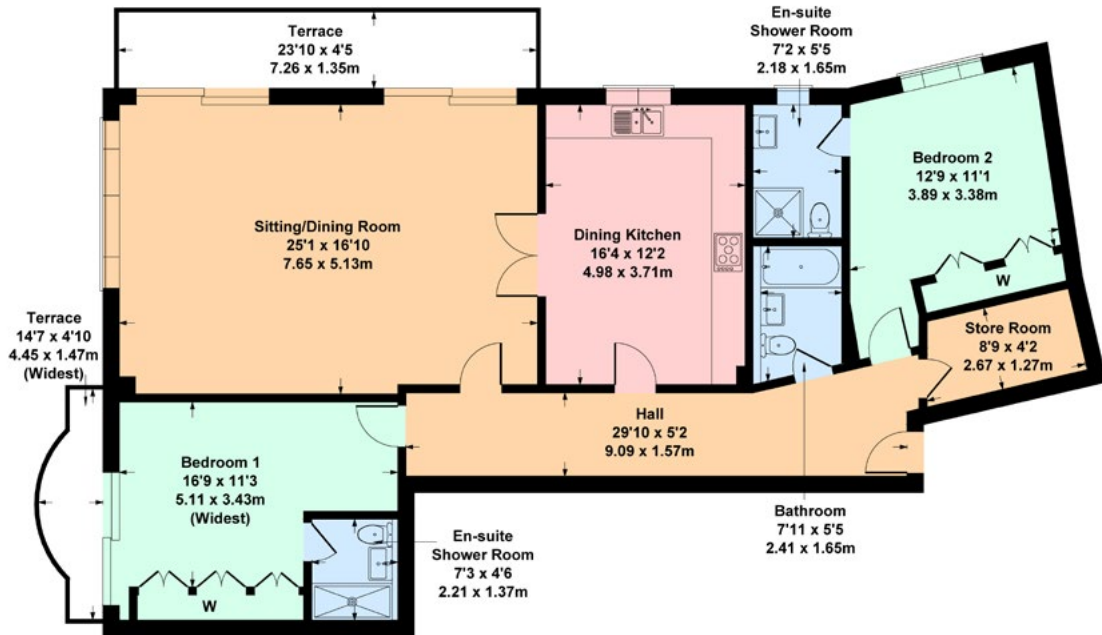

SKETCH PLAN FOR ILLUSTRATIVE PURPOSES ONLY

All measurements, walls, doors, windows, fitting and appliances, their sizes and locations are approximate only. They cannot be regarded as being a representation by the seller, nor their agent. produced by Potterplans Ltd. 2022

We believe these details to be accurate however it is not guaranteed and they do not form any part of a contract. Fixtures and fittings are not included unless specified in the enclosed. Photographs are for general information and it must not be inferred that any item is included for sale with the property. All distances and measurements are approximate. Floorplans may not be to scale and are for illustration purposes only.



Viewing

By appointment through
Nicol Estate Agents
46 Ayr Road
Newton Mearns, Glasgow G46 6SA
Telephone 0141 616 3960
mail@nicolestateagents.co.uk

Outgoings

East Renfrewshire Council
Council Tax: Band G

Fixtures and Fittings

Only items specifically mentioned in the sale particulars are included in the sale price.

Energy Efficiency Rating

Band B

Services

The property will be supplied by mains water, electricity, gas and drainage. Gas central heating.

Local Authority

East Renfrewshire Council
Eastwood Park
Rouken Glen Road
Giffnock
G46 6UG
Tel: (0141) 577 3000

Property Reference 2804

46 Ayr Road, Newton Mearns, Glasgow G46 6SA

T: 0141 616 3960 F: 0141 258 2761 E: mail@nicolestateagents.co.uk

www.nicolestateagents.co.uk

