



O'MALLEY

O'MALLEY

34 Broompark West
Menstrie, FK11 7AL

omalleyproperty.com
01259212337



Description

Welcome to this charming two-bedroom end-terrace bungalow nestled in the heart of Broompark West, Menstrie. Boasting a unique and inviting ambiance, this residence is characterised by its thoughtful extension, providing an additional bedroom and a delightful conservatory, seamlessly blending modern comfort with classic appeal.

As you approach the property, the end-terrace setting ensures added privacy and a sense of exclusivity.

Step inside to discover a well-appointed living space where traditional elements harmonise with contemporary upgrades. The heart of the home unfolds in the living room, offering a cosy retreat adorned with tasteful décor and ample natural light.

The conservatory, a true highlight of the property, serves as a versatile space flooded with sunlight—a perfect spot for enjoying morning coffee, reading a book, or entertaining guests in a tranquil setting.

The master bedroom is a serene retreat, boasting comfort and style. Both bedrooms are thoughtfully designed, offering a peaceful escape at the end of the day. The bathroom is modern and well-appointed, ensuring convenience and relaxation.

Outside, the well-manicured garden and patio area create an idyllic space for outdoor activities, whether it's gardening, al fresco dining, or simply enjoying the fresh air. The end-terrace location provides a larger plot and a sense of seclusion, making the property feel like a private oasis.



“Spacious Property”

Location

Conveniently located in the sought-after Broompark West neighborhood of Menstrie, this bungalow offers proximity to local amenities, schools, and parks. With its unique features, thoughtful design, and a blend of indoor and outdoor living spaces, this two-bedroom end-terrace bungalow in Broompark West invites you to experience a harmonious lifestyle in a tranquil and welcoming community.

Living Room

19'7" x 10'5"

Conservatory

10'5" x 10'5"

Kitchen

9'7" x 7'4"

Bedroom 1

13'7" x 9'8"

Bedroom 2

10'11" x 9'9"

Bathroom

6'5" x 5'11"

Home Report

The home report is available upon request.



Offers Over £119,995

Viewing 9am - 9pm 7 days a week

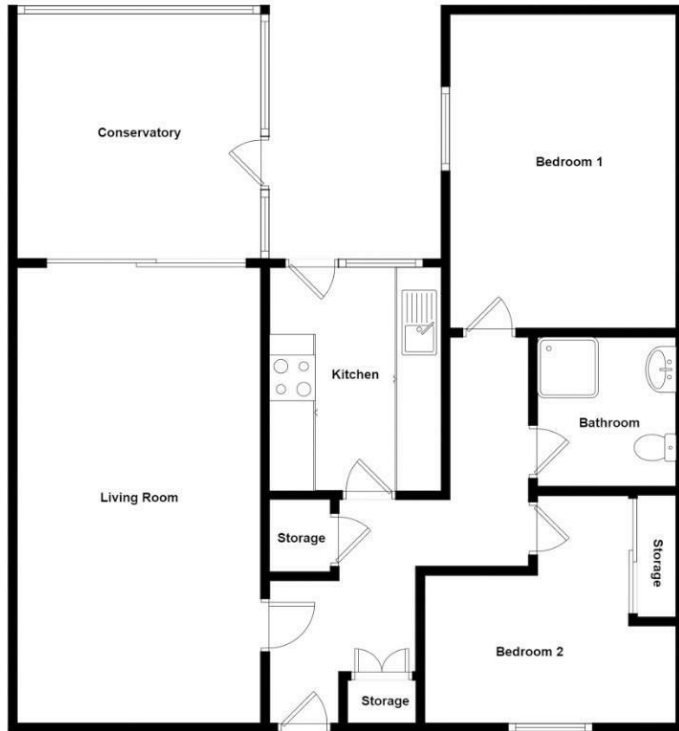

Whilst every attempt has been made to ensure the accuracy of the floorplan contained here, measurements of doors, windows, rooms and any other items are approximate and no responsibility is taken for any error, omission or mis-statement. This plan is for illustrative purposes only and should be used as such by any prospective purchaser. The services, systems and appliances shown have not been tested and no guarantee as to their operability or efficiency can be given.



Property Misdescriptions Act 1991.
While these particulars have been carefully compiled and are believed to be accurate, no warranty is given in this respect and potential purchasers should satisfy themselves as to any points arising therefrom. None of the items included in the sale of working or running nature such as central heating installation or mechanical or electrical equipment have been tested by us and no warranty is given in this respect and potential purchasers should satisfy themselves as to any points arising therefrom. Any photographs used are purely illustrative and may demonstrate only the surroundings. They are not therefore taken as indicative of the extent of the property, or that the photograph is taken from within the boundaries of the property, or of what is included in the sale.