



1 Johnstone Road

Hamilton, ML3 7GA

Offers in excess of £109,000

PRICE CHANGE!

Looking for an immaculate, spacious ground floor apartment close to all of Hamilton's amenities?

Rarely available this well presented property comprises entrance hall, large lounge, fitted dining kitchen with all appliances, two double bedrooms (both with mirrored wardrobes) and bathroom.

Further benefits include a landscaped rear communal garden, designated parking and visitors parking to front and a secure door entry system. EPC C.

Internal viewing a must! Please call to view!

- rarely available lower flat
- Close to Town Centre and all amenities
- Two Double Bedrooms
- Designated Parking
- Communal Rear Garden
- Secure Door Entry System
- Fitted kitchen with all appliances

Viewing

Please contact our Pomphreys Properties Ltd Office on 01698373365 if you wish to arrange a viewing appointment for this property or require further information.



2



1



1



Floor Plan

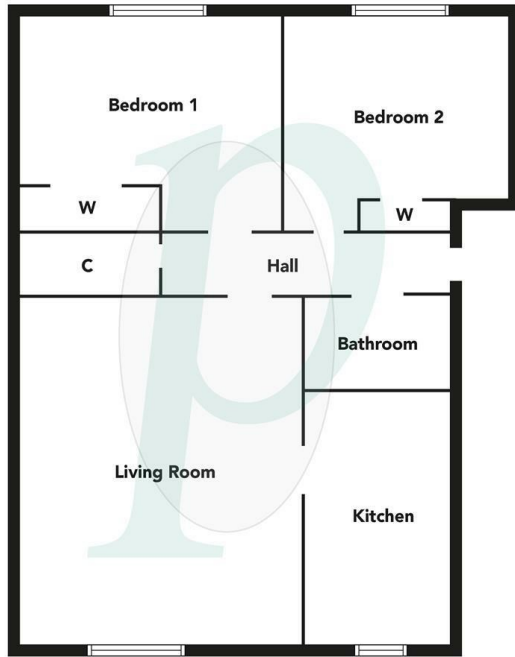

Floorplans are indicative only - not to scale
Produced by Plush Plans Ltd

Area Map



Energy Efficiency Graph



These particulars, whilst believed to be accurate are set out as a general outline only for guidance and do not constitute any part of an offer or contract. Intending purchasers should not rely on them as statements of representation of fact, but must satisfy themselves by inspection or otherwise as to their accuracy. No person in this firm's employment has the authority to make or give any representation or warranty in respect of the property.