



## 11 Bartonhall Road

, Wishaw, ML2 8EP

**Offers over £73,000**

Pomphreys Properties are delighted to present to the market this two bedroom semi detached home, cul-de-sac sited and situated within the popular pocket of Waterloo Wishaw.

The property lower level comprises of a welcoming reception hallway, spacious lounge with dual aspects and kitchen. The upper level boasts two double bedrooms, shower room and large storage cupboard.

Set within landscaped enclosed gardens to front and rear.

Situated within Waterloo, minutes from the Town Centre of Wishaw which boasts a variety of shops, supermarkets, health centre, leisure centre, bars and restaurants. There are primary and secondary schools close by. Wishaw train station is a short distance away and provides access to both Edinburgh and Glasgow. The property is ideal for commuting throughout the central belt with the M8 and M74 a short drive away.

EPC E

### Viewing

Please contact our Pomphreys Properties Ltd Office on 01698373365 if you wish to arrange a viewing appointment for this property or require further information.

- Cul-de-sac sited within Waterloo
- Two double bedrooms
- Gardens to front and rear
- Double Glazing
- Gas Central Heating



2



1



1





## Floor Plan

11 Bartonhall Road, Wishaw

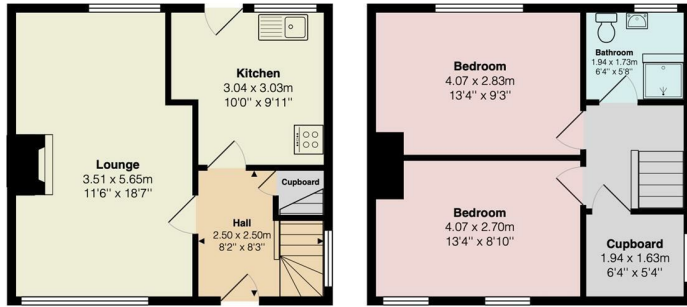

Ground Floor

First Floor

Total Area: 68.8 m<sup>2</sup> ... 741 ft<sup>2</sup>

All measurements are approximate and for display purposes only

## Area Map



## Energy Efficiency Graph



These particulars, whilst believed to be accurate are set out as a general outline only for guidance and do not constitute any part of an offer or contract. Intending purchasers should not rely on them as statements of representation of fact, but must satisfy themselves by inspection or otherwise as to their accuracy. No person in this firm's employment has the authority to make or give any representation or warranty in respect of the property.