



8 The Roundel

, Wishaw, ML2 8JQ

Offers over £48,000

NEW TO THE MARKET

Ground floor flat, in need of modernisation

Spacious accommodation comprising entrance hall, large lounge, 2 double bedrooms, fitted kitchen and wet room.

Double Glazing. Gas Central Heating. Private garden to side and small communal to rear

EPC C

Wishaw offers a great selection of shops, bars, restaurants and leisure facilities. It is perfectly located for the commuter, with the M74 providing convenient access to the central belt. The town also offers excellent public transport, with train and bus services providing links to the surrounding areas.

Viewing

Please contact our Pomphreys Properties Ltd Office on 01698373365 if you wish to arrange a viewing appointment for this property or require further information.

- Two double bedrooms
- side garden
- good location
- in need of upgrade
- Wet Room
- Double Glazing
- Gas Central Heating



2



1



1



Floor Plan

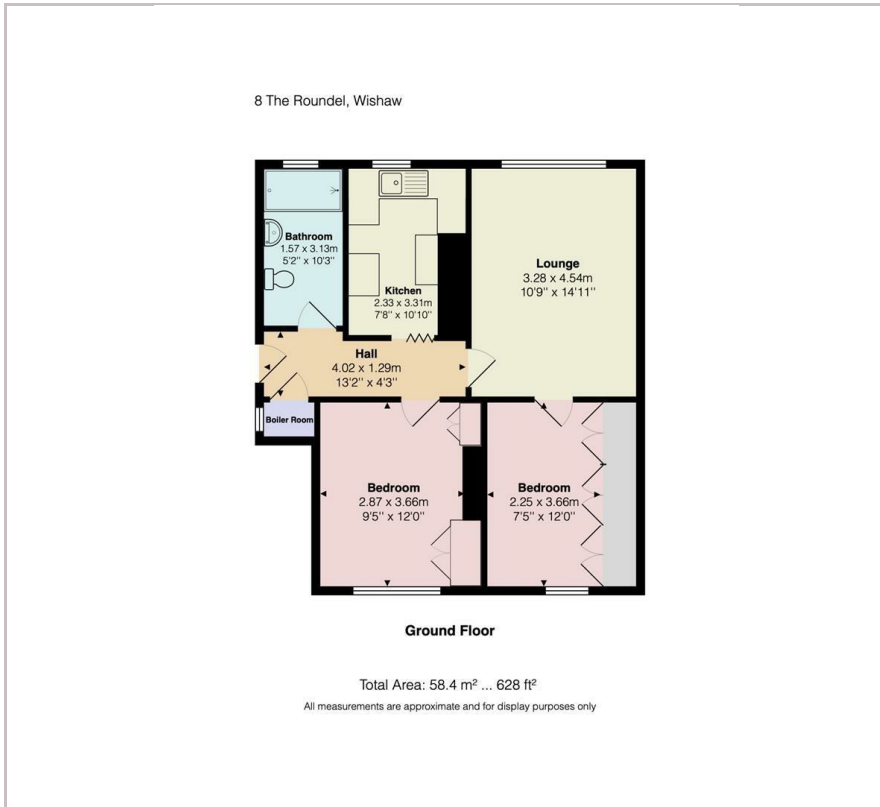

Area Map



Energy Efficiency Graph



These particulars, whilst believed to be accurate are set out as a general outline only for guidance and do not constitute any part of an offer or contract. Intending purchasers should not rely on them as statements of representation of fact, but must satisfy themselves by inspection or otherwise as to their accuracy. No person in this firm's employment has the authority to make or give any representation or warranty in respect of the property.