



2 Turners Avenue, Paisley, Renfrewshire, PA1 2PY



This larger style two bedroom corner sided ground floor modern flat has been well maintained by the current owners and is presented to the market in good decorative order throughout.

The property is spacious, well proportioned and is ideally positioned within a sought after and popular residential development. The property offers accommodation comprising of a welcoming reception hallway, corner lounge with dual aspect double glazed windows, fitted kitchen offering ample storage, two bedrooms (bedroom No. 1 with fitted mirror wardrobes) and an adapted shower room. The property features electric heating, double glazing, security door entry system, allocated private parking and residents communal landscaped gardens.

The property enjoys an excellent setting and is well placed for all of Paisley's local amenities including nearby shopping and schooling. Local transport links provide quick and easy access to the surrounding areas including Braehead, X-scape, Glasgow Airport and Glasgow City Centre.

Early viewing is strongly advised in order to avoid disappointment.

Please refer to published Home Report for EER Band.





2 Turners Avenue, Paisley, Renfrewshire, PA1 2PY

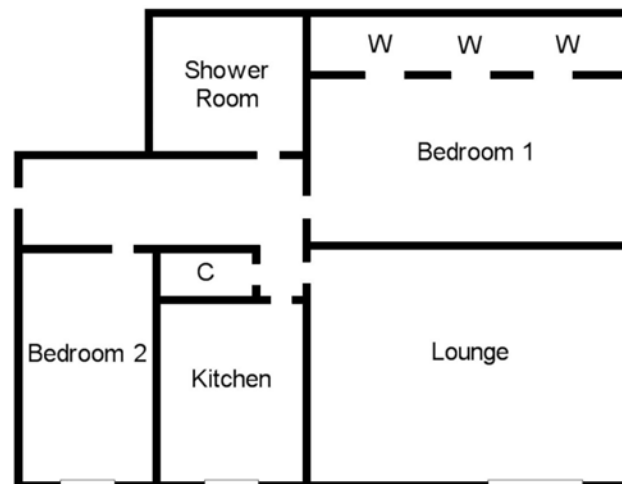

To view contact:

Countrywide Paisley CWN
5 Causeyside Street, Paisley, Renfrewshire, PA1 1UW
Telephone: 0141 848 1155
e-mail: paisley@countrywidennorth.co.uk

Reference: PA1190206

Office opening hours:
Mon & Tue: 9.00am - 5.30pm
Wed & Thu: 9.00am - 7.00pm
Fri: 9.00am - 5.00pm
Sat: 9.00am - 1.00pm

ACCOMMODATION

LOUNGE - 13'7" x 12'6" (4.14m x 3.8m)

KITCHEN - 8'4" x 7'5" (2.54m x 2.26m)

BEDROOM 1 - 10'6" x 10'6" (3.2m x 3.2m)

BEDROOM 2 - 11'7" x 7'2" (3.53m x 2.18m)

SHOWER ROOM - 6'10" x 6'3" (2.08m x 1.9m)

www.countrywidescotland.co.uk