

Ground Floor Plan

Dining	2700mm x 3345mm	8'10" x 11'0"
Lounge	4800mm x 3245mm	15'9" x 10'8"
Family	2785mm x 3245mm	9'2" x 10'8"
Kitchen	2785mm x 3200mm	9'2" x 10'6"
W/C	2025mm x 1800mm	6'8" x 5'11"

Total Floor Area: 129m²

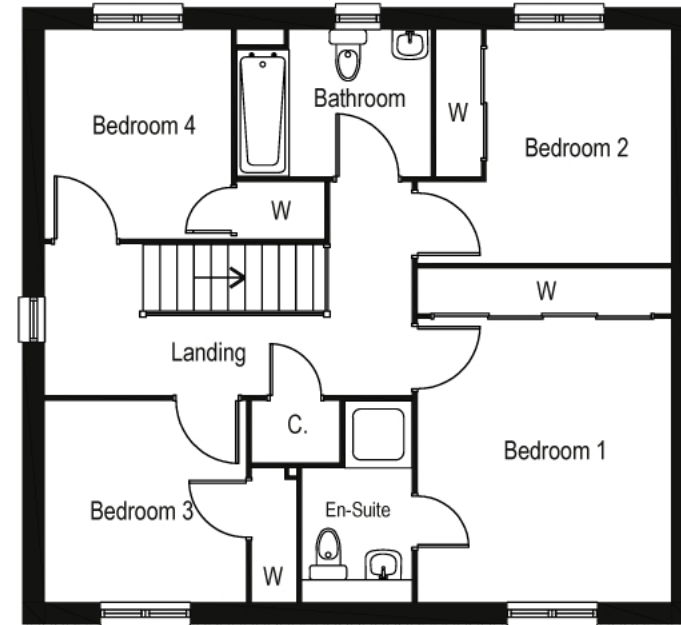

First Floor Plan

Bedroom 1	3800mm x 3400mm	12'6" x 11'2"
Bedroom 2	3125mm x 2475mm	10'3" x 8'1"
Bedroom 3	2700mm x 2700mm	8'10" x 8'10"
Bedroom 4	2800mm x 2500mm	9'2" x 8'2"
Bathroom	1965mm x 2600mm	6'5" x 8'6"
En Suite	2700mm x 1475mm	8'10" x 4'10"

All measurements given above are approximate and intended as a guide only